

MACKLOW SMITH TENSION & COMPRESSION LOAD CELL

Series MST S15 & S16

Applications

Test machines, calibration of test machines both in tension and compression, load measurement for process control, measuring the load applied in presses, small tanks and silos, hanging scales.

Design Features

The standard design incorporates a design in the form of a letter S which is suitable for both tension and compression forces, metric threads are standard, UNF threads are available, negating the need for extra plates.

High accuracy throughout the range of 0.05% RO, manufactured in plated tool steel or stainless steel and sealed to IP67/IP68 depending on model. The S15 design is manufactured nickel plated alloy steel, the S16 design is manufactured in stainless steel. Extensive model range of eight capacities offering 0.5kN through to 10kN

Calibration

These load cells can be supplied with a Macklow-Smith works calibration certificate traceable to national standards or a UKAS calibration certificate. They can also be supplied tested and ready for calibration by the customers preferred test laboratory.

Options

Cable plug connections for display/data logger
Ball seat fittings
Platens with spherical seats
Rod eye bearings for tension

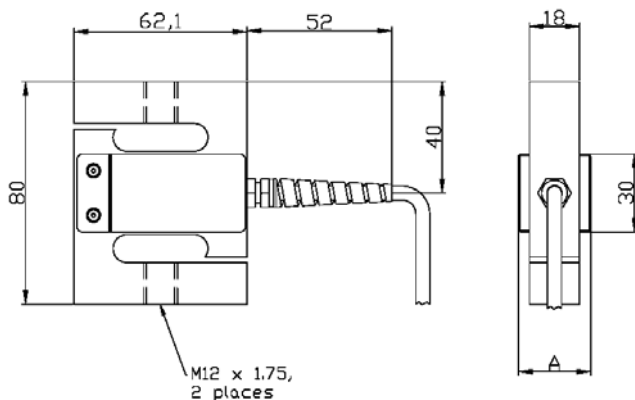

dimensions are in mm

SPECIFICATION



Models	MST S15	MST S16
Capacity	0 – 0.5kN	N/A
Capacity	0 – 1.0kN	0 – 1.0kN
Capacity	0 – 1.5kN	0 – 1.5kN
Capacity	0 – 2.0kN	0 – 2.0kN
Capacity	0 – 3.0kN	0 – 3.0kN
Capacity	0 – 5.0kN	0 – 5.0kN
Capacity	0 – 7.5kN	0 – 7.5kN
Capacity	0 – 10.0kN	0 – 10.0kN
Dimension A	22mm	26mm
Thread size	M12 x 1.75 standard 1/2" – 20 UNF special order	
Rated output	2.0mV/V ± 0.2%	
Linearity	± 0.05% of rated output	
Non repeatability	± 0.05% of rated output	
Zero Return (30min)	± 0.05% of applied load	
Zero balance	± 1% of rated output	
Operating temperature	-30°C - +70°C	
Compensated temp'	-10°C - +40°C	
Temp' effect on output	± 0.003% of applied load/°C	
Temp' effect on zero	± 0.01% of rated output/°C	
Safe overload	150% of rated capacity	
Ultimate overload	300% or rated capacity	
Excitation recommended	10V AC or DC	
Excitation maximum	15V AC or DC	
Input impedance	400 Ω nominal	
Output impedance	350 Ω nominal	
Insulation resistance	>2 GΩ at 50 V DC	
Construction	Plated Alloy steel	Stainless steel
Weight	0.6kg	0.8kg
Environmental	IP20	
Cable (standard)	3m x 6 core screened	

In the interest of product development we reserve the right to alter specifications without prior notice.

MACKLOW-SMITH

TEST EQUIPMENT

Dragon Lodge,
Frensham, Farnham,
Surrey, GU10 3DQ, U.K.
Telephone +44 (0) 1252 790187
Facsimile +44 (0) 1252 793387
Email sales@macklow-smith.com
Web: www.macklow-smith.com